

2 bag power flow collection system





2 bag power flow collection system



Zero-Turn Mower 54 in. 6.5 Bushel Twin Bagger

The 6.5 bu (229 l) 2-bag rear bagger efficiently collects material from the mower deck. Attachment kit includes hopper, chute, and ballast needed for operation, zero turn mower is sold separately. It is designed to provide efficient bagging performance, clean operation and easy-to-empty bags. No tools are needed to install or remove, after initial installation.

BUC11233: Material Collection System, 2-Bag Attachment

BUC11233: Material Collection System, 2-Bag Attachment. Part Number: BUC11233. Improved Efficiency: The BUC11233 7-bushel two-bag hopper assembly enhances the efficiency of grass collection, providing a convenient solution for collecting grass clippings and leaves using either the cut-and-throw rear bagger or the Power Flow material collection system (MCS).



John Deere 2-bag 6.5-bushel Bagger Attachment

John Deere 2-bag 6.5-bushel Bagger Attachment - BG20757-John Deere 2-bag 6.5-bushel Bagger Attachment
The 6.5-bushel rear bagger efficiently collects m Z525E, Z535M, and Z540M use a chute in conjunction with the Power Flow blower. Standard mower blades are used for bagging. Air exhaust duct directs air from the hopper back and toward the

[John Deere Power Flow for sale](#)



Flat Idler Pulley for John Deere 1 & 2-Bag Power-Flow Material Collection System. Brand New. \$14.49. Free shipping. JOHN DEERE 54C POWERFLOW BM20668 LX277 LX279 LX280 LX289 GX325 GX335 GX345 GX355. Open Box · John Deere. \$619.99. or Best Offer. Free shipping. New John Deere Power Flow Bagger hood latches. Brand New · John Deere.



- LiFePO₄
- Wide temp: -20°C to 55°C
- Easy to expand
- Floor mount&wall mount
- Intelligent BMS
- Cycle Life:≥6000
- Warranty :10 years



The ROP Shop , Flat Idler Pulley for John Deere 1 & 2-Bag Power-Flow

The ROP Shop replacement Flat Idler Pulley for John Deere 1 & 2-Bag Power-Flow Material Collection System ; Specs - Inner Diameter: 3/8". Outer Diameter: 3 7/8". Height: 1 1/8". Material Type: Metal. Refer to images 2 & 3 for more information ; Includes - (1) Flat Idler Pulley; comes as shown in the first image

John Deere 14-Bushel 3-Bag Rear Bagger Hopper ...

The 3-bag hopper installs to the tractor with the Click-N-Go(TM) mounting system. BM20714 Click-N-Go brackets must be ordered separately. BM21682 Power Flow lower chute must be ordered separately; Also order appropriate blower below: ...

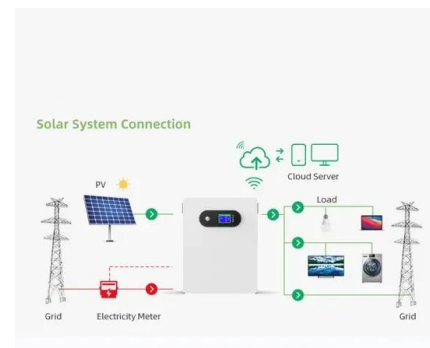

[John Deere Chute Kit BM21681](#)

John Deere Chute Kit BM21681. Power Flow Chute for 2 Bag Material Collection System Hopper. The Power Flow chute is required, along with the high-performance Power Flow blower, to use the 2-bag Power Flow material collection system. The chute includes a convenient handle and a fill indicator that tells the operator when the bags are getting full.



John Deere 6.5-bushel 2-Bag Material Collection Hopper ...

The 6.5-bu (229-L) rear bagger efficiently collects material from the mower deck: For an EZtrak Z225 or Z245, a chute (ordered separately) moves material from the mower deck to the 2-bag ...



2018 John Deere 2-bag Power Flow Collection System

2-bag Power Flow Collection System Provides an efficient means of collecting grass clippings and leaves using the Power Flow material collection system. Key Features



BM21680: Material Collection System Attachment, 3 Bag, 14 ...

BM21680: Material Collection System Attachment, 3 Bag, 14 Bushel, 48A/54A inch. Part Number: BM21680. Large 14-bu (493-L) capacity allows for extensive grass or leaf collection before needing to stop. No-tools installation and removal for easy setup and maintenance.

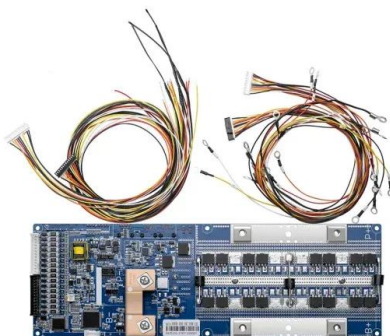

John Deere Material Collection System for 48A Deck

The BUC10126 6.5-bu Power Flow grass collection system includes the hopper, chute, and blower. Mower blades are not included, as the bagger works well with either the standard side-discharge blades or mulching blades and the MulchControl system. It expands versatility of an S240 Tractor equipped with a 48-in. (122-cm) Accel Deep Mower Deck.



[John Deere 7-bushel Hopper for MCS](#)

5 4 3 2 1. Name: * Email provides an efficient means of collecting grass clippings and leaves using either the cut-and-throw rear bagger or the Power Flow material collection system (MCS). not included The hopper design provides modern styling, great bagging performance, cleaner operation, and easy-to-empty bags. The 7-bushel MCS



[Material Collection system for the JD1023e](#)

I say Deere with the 3 bag power flow collection system. John Deere 3 Bag Powerflow MCS 14 Bushel John Deere 3 Bag Collection System for 1023E, 1025R, 1026R, 2305, 2320, 2520, 2720, 2025R, 2032R Compact Tractors The power flow system has a blower that hangs on the right side of the deck thats powered off the deck with a belt. Reactions



John Deere 6.5-bushel 2-Bag Material Collection Hopper Assembly

Two durable bags give a generous, 6.5-bu (229-L) capacity. The bags lift out for easy emptying. Efficient chute provides a smooth flow of material to reduce the chance of plugging. Z225 and Z245 use a cut-and-throw chute. Z425, Z445, Z645 and Z655 use a chute in conjunction with the Power Flow blower. Standard mower blades are used for bagging.



[Two Bag Power Flow Collection System](#)

Loose-knit Bag For 7-Bushel Hoppers. (0) \$58.52. Add To Cart. HP Power Flow Blower Assembly BG20748. (0) \$708.34. Add To Cart. HP Power Flow Blower Assembly for 54A Mowers ...



**Low Voltage
Lithium Battery**
6000+ Cycle Life

BUC10907: 2-Bag Material Collection System, 6.5 Bushel

BUC10907: 2-Bag Material Collection System, 6.5 Bushel. Part Number: BUC10907. BUC10907 is a 6.5-bushel (229-liter) hopper and chute designed for use with a 42-in. (107-cm) Accel Deep (42A) mower deck. It offers efficient bagging performance and easy-to-empty bags, also known as a material collection system (MCS).



BM20671: Material Collection Hopper Attachment, 3 Bag, 14 Bushel

BM20671: Material Collection Hopper Attachment, 3 Bag, 14 Bushel. Part Number: BM20671. The BM20671 hopper assembly is designed for use with specific mower decks, including the 48-inch (122-cm) Accel Deep (48A) Mower Deck, convertible, and high-capacity mower decks. The material collection system hopper attachment that efficiently collects

John Deere 2 Bag 6.5 Bushel Hopper for Eztrak Residential Mowers BM23634

The 6.5-bu (229-L) rear bagger efficiently collects material from the mower deck: For an EZtrak Z225 or Z245, a chute (ordered separately) moves material from the mower deck to the 2-bag hopper. For an EZtrak Z425, Z435, or Z445, a Power Flow blower (ordered separately) on the end of the mower deck moves material up



the chute (ordered separately) and into the hopper. The ...



- LIQUID/AIR COOLING
- ON GRID/HYBRID
- PROTECTION IP54/IP55
- BATTERY /6000 CYCLES

John Deere 2-bag 6.5-bushel Bagger Attachment

John Deere 2-bag 6.5-bushel Bagger Attachment. The 6.5-bushel rear bagger efficiently collects material from the mower deck: For a Ztrak Z525E, Z535M, or Z540M, a Power Flow blower (ordered separately) on the end of the mower ...

48C

Blower Housing (48C) 60 Three-Bag Powerflow Material Collection System 48C - ATTACHMENT, MOWER DECKS AND 2 & 3 BAG POWERFLOW MATERIAL COLLECTION SYSTEM POWER FLOW BLOWER A EPC John Deere online CCE 19M7867 Screw JD8535 Ball Bearing AVS.PARTS. Case CNH EPC; Deere EPC; Contacts; Request list; 0

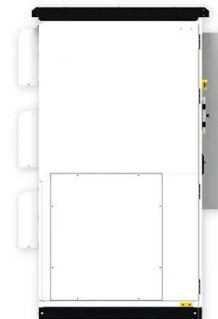

[Triple Bagger, Power Flow and Chute](#)

The 14-bu (493-L) 3-Bag Power Flow Material Collection System increases the versatility of X700 Series Tractors equipped with a 60-in. High Capacity mower deck. The large, 14-bu capacity means the operator can collect a large area of grass or ...





BUC11514: 2-Bag Hopper Material Collection System

BUC11514: 2-Bag Hopper Material Collection System. Part Number: BUC11514. The 6.5-bu (229-L) rear bagger efficiently collects material from the mower deck, ensuring a clean and tidy mowing process. The Power Flow(TM) blower efficiently moves material up the chute and into the hopper, providing continuous and effective bagging performance.

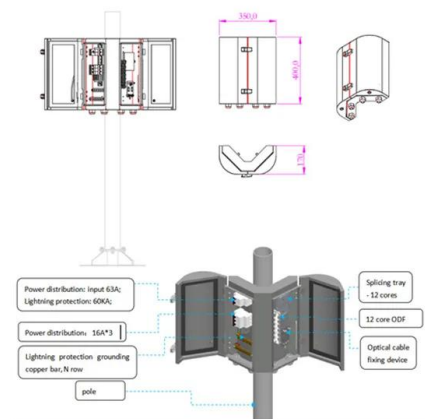

2-Bag Material Collection System for 42-Inch, 48-Inch, and ...

2-Bag Material Collection System for 42-Inch, 48-Inch, and 54-Inch Accel Deep(TM) Mower Decks on Z300 Series ZTrak *OMUC32588* OMUC32588E ISSUE G2 (ENGLISH) CALIFORNIA Power Flow(TM) High Performance GXT002440--UN--12JUL15 A--WARNING (M158480) vs70618,1653301582438-19-19JUL22

John Deere 7-Bushel 2-Bag Rear Bagger Hopper Assembly

John Deere 7-Bushel 2-Bag Rear Bagger Hopper Assembly - BM20780-John Deere 7-Bushel 2-Bag Rear Bagger Hopper Assembly The hopper design provides moder Hopper installs to tractor with Click-N-Go(TM) mounting system ; BM21681 Power Flow lower chute must be ordered separately; Also order appropriate blower below: BM22696 48 deck Power Flow



INSTALLATION INSTRUCTIONS 6 bu Material Collection ...

5 6 BU MATERIAL COLLECTION SYSTEM. Parts in Kit. D C B A. Hardware. DescriptionLetter Qty. Adjustment Link D 2 3/8" x 1" Carriage Bolt Hardware bag 2 3/8" Nylock Nut Hardware bag 2 3/8" Plastic Washer Hardware bag 2 3/8" Flat Washer Hardware bag 4 3/8" Jam Nut Hardware



bag 4 3/8" x 1- 3/4" Bolt Hardware bag 1 3/8" Flange Nut

Zero-Turn Mower 54 in. 6.5 Bushel Twin Bagger

Up to 8% cash back. 2 durable bags give a generous, 6.5 bu. (229 l) capacity and the bags lift out for easy emptying. Efficient chute provides a smooth flow of material to reduce the chance of plugging. Air exhaust duct directs air from the ...



BM20455: Material Collection Hopper Attachment, 2 Bag, 7 Bushel

The BM20455 Power Flow Chute is compatible with various mower types and is designed to provide efficient material collection and handling during mowing operations. It is a crucial component for attaching a 7-bushel hopper assembly and is essential for ensuring proper airflow and material flow during the collection process.

John Deere Two-Bag Power Flow Material Collection System

Two-Bag-Power-Flow-Material-Collection-System Parts Diagram Attachment, Blower, 48 inch and 54 inch Mower Deck Attachment, Rear Bagger Chute Blower Housing (Power Flow) (W/38-Inch Deck) Blower Housing And Brackets, 48 inch and 54 inch Mower Deck





BUC10907: 2-Bag Material Collection System, 6.5 Bushel

BUC10907 is a 6.5-bushel (229-liter) hopper and chute designed for use with a 42-in. (107-cm) Accel Deep (42A) mower deck. It offers efficient bagging performance and easy-to-empty ...

[Twin Bagger, Power Flow and Chute.](#)

The Chute is required, along with the high-performance Power Flow blower, to use the 2-bag Power Flow material collection system. The chute includes a convenient handle and a fill indicator that tells the operator when the bags are getting full. One chute works with several vehicle applications. Trim lines on the chute are referenced in the



BG20747: Material Collection System Hopper Attachment, 2 Bag, ...

BG20747: Material Collection System Hopper Attachment, 2 Bag, 6.5 Bushel, 54 inch. Part Number: BG20747. Large Hopper Capacity: Generous 14-bushel capacity with easy-to-empty bags for customer convenience. Power Flow grass collection system is lightweight, rust-resistant, and allows direct filling into bags for easy emptying.



BUC10911: Material Collection System, 2-Bag Attachment

BUC10911: Material Collection System, 2-Bag Attachment. Part Number: BUC10911. Efficient Material Collection: The 6.5-bushel hopper, chute, and Power Flow blower provide an efficient ...



Contact Us

For catalog requests, pricing, or partnerships, please visit:
<https://vdbconstruction.co.za>