

# How to charge 36v lithium battery





## Overview

---

How to charge a 36V battery?

Constant voltage charging is the most common method used for charging 36v batteries. It involves applying a constant voltage to the battery until it reaches its full charge capacity. This method requires a charger that can regulate the voltage and limit the current to prevent overcharging.

How long does it take to charge a lithium battery?

The time it takes to charge a lithium battery depends on several factors, including the power output of the charger and the capacity of the battery. Generally, charging a lithium battery can take anywhere between 1-4 hours, depending on the specific charger and battery combination.

What is a 36 volt battery?

Before diving into the charging process, it is important to understand the basics of 36v batteries. A 36v battery consists of a series of 12v cells connected together to provide a total voltage of 36 volts. These batteries are commonly used in electric bikes, scooters, and other electric vehicles.

Is it safe to leave a 36V battery charging overnight?

It is generally safe to leave a 36v battery charging overnight, but precautions should be taken. Ensure the charging area is well-ventilated and away from flammable materials. Additionally, using a charger with automatic shut-off or overcharge protection can provide peace of mind and prevent overcharging the battery.

What voltage should a lithium battery be charged?

Understanding the charging voltages for lithium batteries is crucial for maintaining battery health and performance. This includes knowing the appropriate voltages for the bulk, absorption, and float stages of charging. For lithium batteries, the recommended voltage range for battery charging is



between 14.2 and 14.6 volts.

Can a generator charge a lithium battery?

Generators can also be used to charge lithium batteries, providing a convenient source of power when other charging options are unavailable. Using a charger specifically designed for lithium batteries and compatible with your system is required for safe and efficient charging.



## How to charge 36v lithium battery



### What Should a 36V Battery Charge at? (In-depth Analysis)

In this article, we will delve into the world of battery voltage, explore factors to consider before charging a 36V battery, discuss recommended charging voltages for different ...

### How to charge a 36V lithium ion battery? , Redway Battery

Charging a 36V lithium-ion battery correctly is essential for ensuring its longevity and optimal performance. This guide outlines the necessary steps and precautions for safely ...

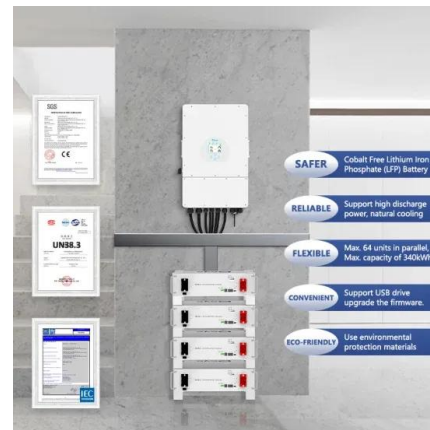

### Understanding the Charging Time for a 36V Lithium Battery

Charging a 36V lithium battery efficiently requires a nuanced understanding of several critical factors. From the battery's capacity to the charger's specifications, various elements influence how long it takes to achieve a full charge. This article provides an in-depth look into these variables to help users optimize their charging practices and ensure peak ...

### The Ultimate Guide to 36V Batteries: Types, Capacities, and Uses

In this guide, we'll explore different types of 36V batteries, their capacities, sizes, weights, and much more. Part 1: Types of 36V Batteries There



are a few main types of 36V batteries, each with its unique features, chemistry, pros, and cons:  
36V Lithium-Ion (Li



### LiTime 36V 100Ah Lithium Golf Cart Battery - LiTime-US

Elevate your golf cart's performance with a 36V 100Ah lithium battery. Enjoy longer rides, faster charging, and superior durability. Battery for Club Car, EZGO, ICON & Yamaha. Born for Golf Carts(Club Car, EZGO, ICON & Yamaha) EV ...



### How to Test Lithium Ion Battery with Multimeter

Setting Up the Multimeter Once you have selected the right multimeter, it is time to set it up for testing. First, ensure that the multimeter is set to the DC voltage setting. This is because lithium-ion batteries produce a direct current (DC) voltage. Next, attach the red



### [36 Volt \(10S\) Battery Voltage Chart](#)

Nominal voltage chart for 36V (10S) Li-Ion Ebike batteries showing the percentage. 10 Cells x 4.2 Volts/Cell = 42.0 Volts Fully Charged Voltage (V)  
Assumptions: Your pack uses typical 18650 cells which charge to 4.2V and discharge to 3.0V.  
Disclaimer: This chart is a theoretical guide only.



## 36 Volt Lithium Batteries

The best 36 volt lithium batteries. 36V lithium replacement battery for golf carts, electric trolling motors. 11 year warranty. Shop now. 15% Off - Code: SeasonEndSale - Exclusions Apply, Valid 10/28 - 11/30



## Guide to Battery Charging

If your charger puts out 14.2 to 14.6 volts to the battery when charging on the AGM setting it will charge with Ionic lithium batteries. Do not use chargers with "desulfation" mode or equalizer mode that charges above 15V. Below are some specific brands and

## How To Charge A 36v Lithium Battery? - ZPRO ...

Charging a 36V lithium battery requires careful attention to detail and adherence to best practices to ensure safe and efficient operation. By selecting the right charger, following proper charging procedures, and ...



## Everything Anglers Should Know about Lithium ...

I have a 36V charger from Dakota that is an 18Ah and it's a beast of a charger. It will cycle a charge in my trolling motor batteries and have them ready to go in an hour or two. It's crazy how fast these things charge. Lithium ...



### Buy 36 Volt 50Ah Lithium Battery , LithiumHub Ionic

Ionic Multi Voltage 36v Battery Charger Stats  
Most bank chargers are for 12V batteries only - this can charge one 36V and one 12V Lithium (LiFePo4) battery at 10A simultaneously. Green and Red indicator lights for charging status. ...



### Optimal Lithium Battery Charging: A Definitive Guide

Charging a lithium battery pack may seem straightforward initially, but it's all in the details. Incorrect charging methods can lead to reduced battery capacity, degraded performance, and even safety hazards such as overheating or swelling. By employing the correct

### How to Wake Up a 36V Lithium Battery: Comprehensive Guide

To wake up a dormant 36V lithium battery, connect it to an appropriate charger designed for lithium technology. Allow it to charge until it reaches at least a minimum voltage threshold (usually around 30V). If unresponsive, check connections or consult manufacturer



### [How To Charge A 36v Lithium Battery?](#)

Charging a 36V lithium battery requires careful attention to detail and adherence to best practices to ensure safe and efficient operation. ZPRO Lithium stands at the forefront of battery charging technology, offering a ...





### 36V Lithium Battery Charger: How to Choose

Factors to Consider When Choosing a 36V Lithium Battery Charger When it comes to choosing a 36V lithium battery charger, there are several important factors to consider. One key aspect is the charging speed of the charger. Make sure to select a charger that



### **Upgrade Your Ride: 36 Volt Lithium Battery for Golf Cart**

Upgrading to a 36 Volt Lithium Battery for your golf cart changes how you golf. It's a switch from old lead-acid batteries to Lithium batteries. Lithium batteries offer unmatched performance and reliability. Key Takeaways: ...

### How to Use and Install a 36V Battery System

Each of our Battle Born Batteries has a BMS that also "calculates the remaining charge, monitors the battery's temperature, Using Lithium 12V Batteries for 36V System In the past, batteries were commonly made from a lead-acid base. But, we have made



### **12V 24V 36V 48V and 72V Lithium Battery Chargers**

When choosing a lithium charger look for one that is the same voltage as your battery (12V for 12V batteries, 36V for 36V batteries, etc.) and decide how fast you want to charge your battery. The higher the amp rating (A) of the charger, the faster your battery will



## How to Charge Lithium-Ion Batteries: Best Practices

Adhering to voltage requirements, temperature considerations, and lithium battery charging profiles are essential for safe and efficient charging of lithium batteries. Lithium-ion battery charging best practices such as ...



## The Right Way to Charge a Lithium Battery Pack

Charging lithium battery packs correctly is essential for maximizing their lifespan and ensuring safe operation. This guide will provide you with in-depth, step-by-step instructions on how to ...

## AC-DC 36V 20A Lithium LiFePO4 Battery Charger

AC-DC 36V 20A Lithium LiFePO4 Battery Charger AMPTRON® Lithium Iron Phosphate (LiFePO4) battery chargers are state-of-the-art battery chargers with a charging profile specifically designed to charge and maintain Lithium Iron Phosphate (LiFePO4) batteries, and can safely achieve a 100% State of Charge. The 36V 20A model charger operates from mains AC 200 ...



## Complete Guide to 36V LiFePO4 Golf Cart Batteries

In the realm of golf cart batteries, the 36V LiFePO4 (Lithium Iron Phosphate) battery has emerged as a superior choice, offering a range of benefits that far outshine traditional battery types. This comprehensive guide explores every facet of 36V LiFePO4 golf cart batteries, from their defining features to their environmental impact, helping you make an informed ...



### [How to Make a 36 Volt Battery Charger](#)

The appropriate amperage required for safely charging a 36 volt battery depends on the battery's capacity and the charger's specifications. Generally, a safe charging rate is around 10% of the battery's capacity. For example, a 36V battery with a capacity of



### **What is the Maximum Charge Voltage for a 36V Battery?**

Typically, the maximum charge voltage for a 36V lithium-ion battery is 42 volts. This range is carefully calculated to balance performance with safety, ensuring that the battery reaches its full charge without risk of damage. For lead-acid or nickel-metal hydride

### **Charging Lithium Batteries: A Comprehensive Guide**

1. Standard Charging: The standard charging method involves connecting the battery to the charger and allowing it to charge at a moderate rate. This method is safe and ...



### **36V 8A Dakota Lithium LiFePO4 Battery Charger**

6 ???· This 36V lithium charger is rated at 8 amps and will charge a 36V 60Ah battery in





## Charging LiFePO4 Batteries In Parallel And Series Guide

In conclusion, you must have got all the information around lithium batteries and charging lithium phosphate batteries in parallel and series. While LiFePO4 batteries are among the safest lithium-ion chemistries available and the configuration in which they are charged and discharged plays a vital role in their performance and longevity.



## Charging Your E-Bike Lithium Battery: A Comprehensive Guide

How do I Charge a 36V E-Bike lithium Battery? Charging a 36V e-bike lithium battery is simple. First, confirm the battery voltage is 36V. Then, connect the charger to the battery's charging port and plug it into a working outlet. Watch for the charger's LED

## Lithium Battery How to Charge: A Comprehensive Guide

As our reliance on portable electronic devices and renewable energy systems continues to grow, understanding how to properly charge lithium batteries has never been more critical. Among the various types of lithium batteries, Lithium Iron Phosphate (LiFePO4) batteries stand out due to their safety, longevity, and perfo



## Everything You Need to Know About 36 Volt Golf Cart Battery

Currently Vatrer's lithium batteries for golf carts do not support series-parallel connections, and to their credit a customer has verified that the batteries can run up to 20-25 miles per hour on their own, up to 40 miles on a single charge of 36V, up to 50 miles on a



## How to Charge Dakota Lithium and LiFePO4 Batteries

We answer all your questions about charging LiFePO4 batteries. Dakota Lithium has a large variety of battery sizes to power your application. 15% Off - Code: SeasonEndSale - Exclusions Apply, Valid 10/28 - 11/30

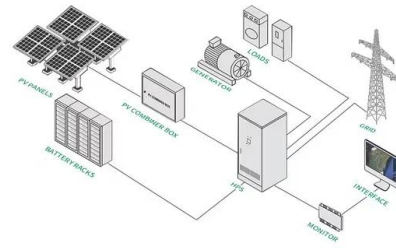

## How to Charge a 36 Volt Lithium-Ion Battery Safely and Effectively

Charging Process. Follow these steps to charge your 36-volt lithium-ion battery safely: Connect the Charger: Attach the charger's connectors to the battery terminals. Make ...

## Contact Us

---

For catalog requests, pricing, or partnerships, please visit:  
<https://vdbconstruction.co.za>